



Website



Facebook



YouTube

Simon|57



Various Colors
Unlimited Creativity

simon
LIGHT UP EMOTIONS

www.simonelectric.com



Simon, S.A.(Spain)

Tel. +34 902 109100

Web. www.simonelectric.com

Simon Electric (China)

Tel. +86 21 3855 5222

Web. www.simon.com.cn

Simon Electric (APAC)

Web. www.simon-apac.com

E-mail. info@simon-apac.com

PT Simon Elektrik Indonesia

Tel. +62 21 52960373

Web. www.simonelektrik.co.id

simon

When Tradition meets Modernity

57 series integrates traditional elements with modern design —the catchy gold and silver collide with the calm, matte black and white, giving the product a classic touch without losing its fashionable appeal.

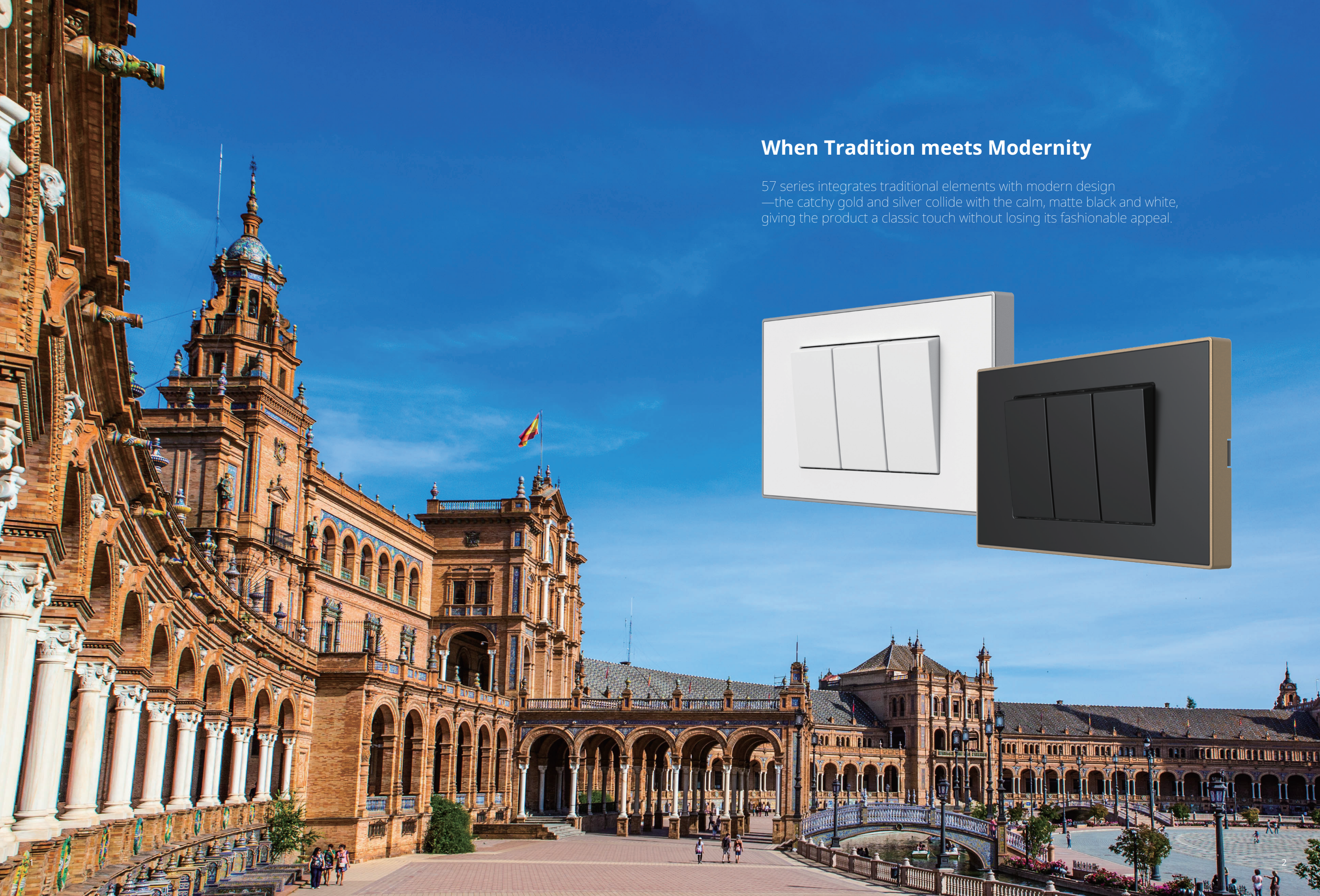
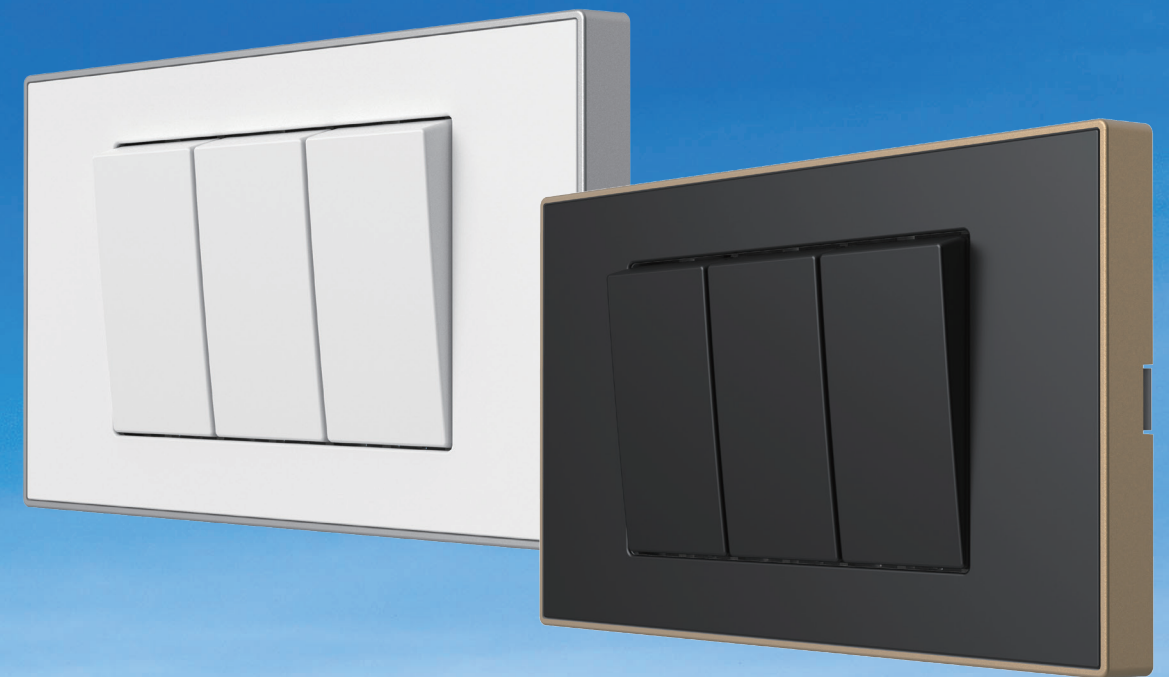

Various Colors, Customize Your Space

No longer limited to plain white or black. Now with 57 series, choose your style and customize your space. The *mysterious black*, the *classic gold*, or the *sleek silver*, all can be combined to add a unique vibe to the space.

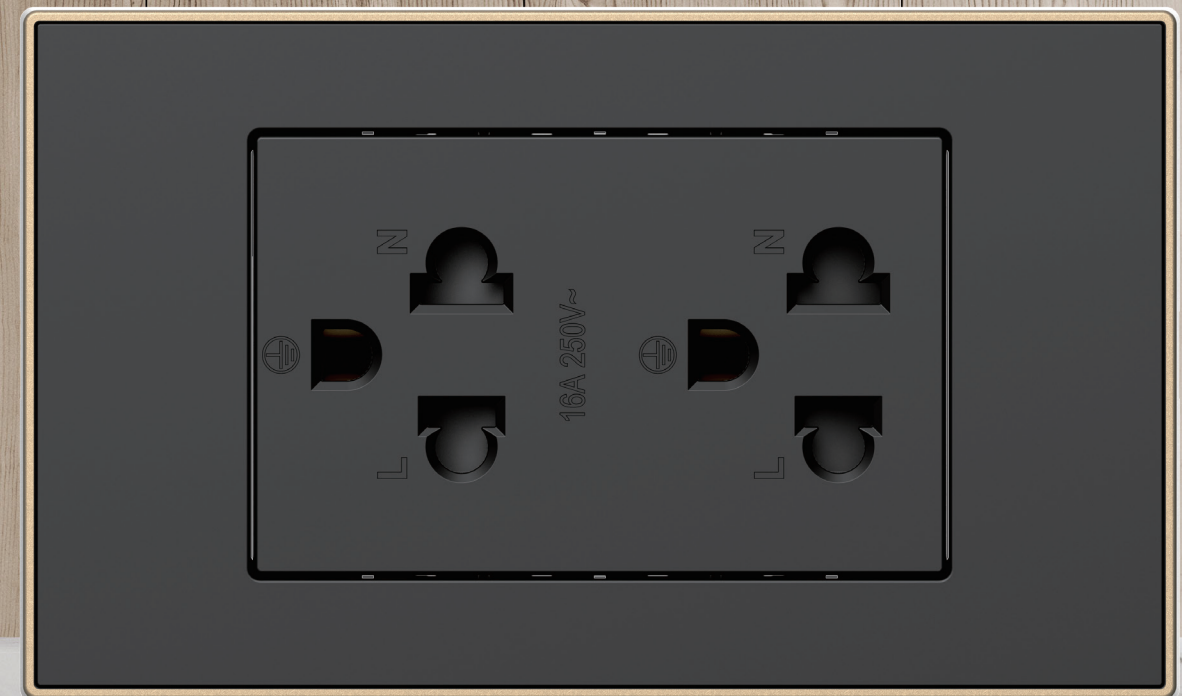

Stay Safe with Waterproof and Dustproof Electricals.

Our integrated waterproof design provides multiple layers of protection, ensuring a sealed enclosure that keeps out water and dust. Experience the ultimate safety in electrical usage.

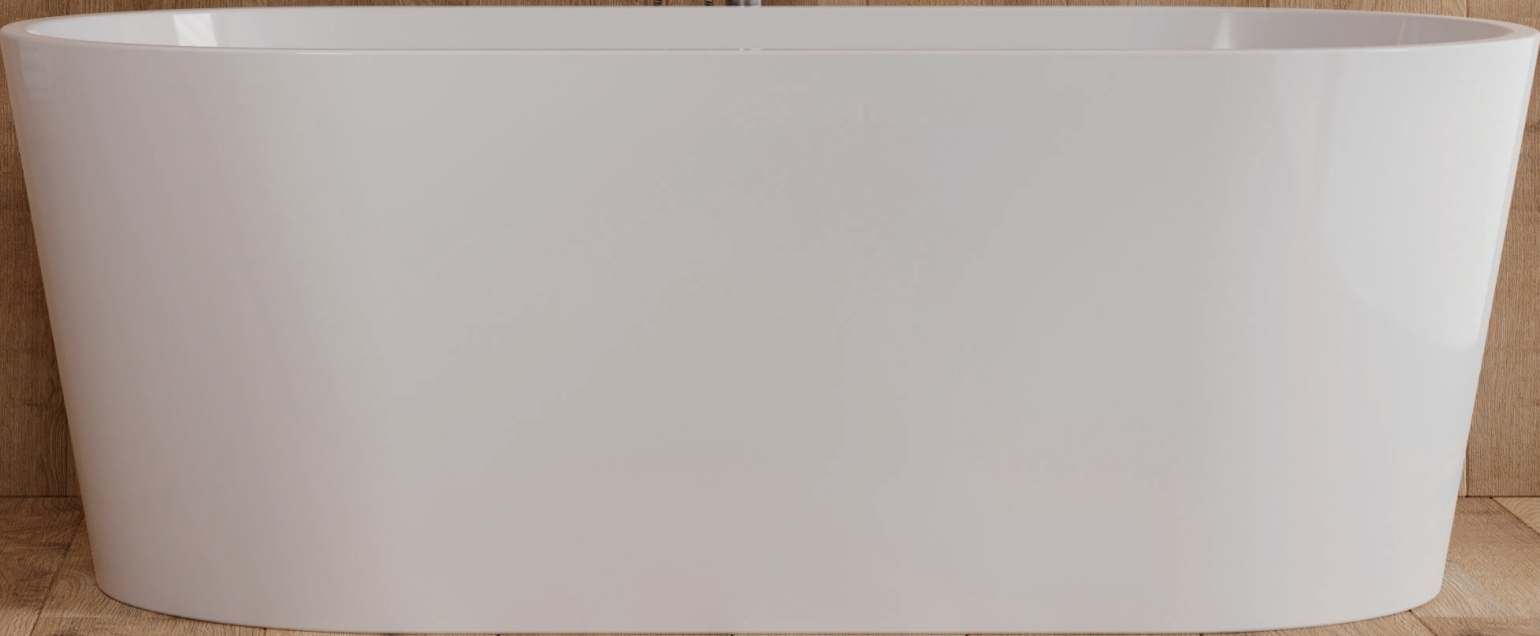
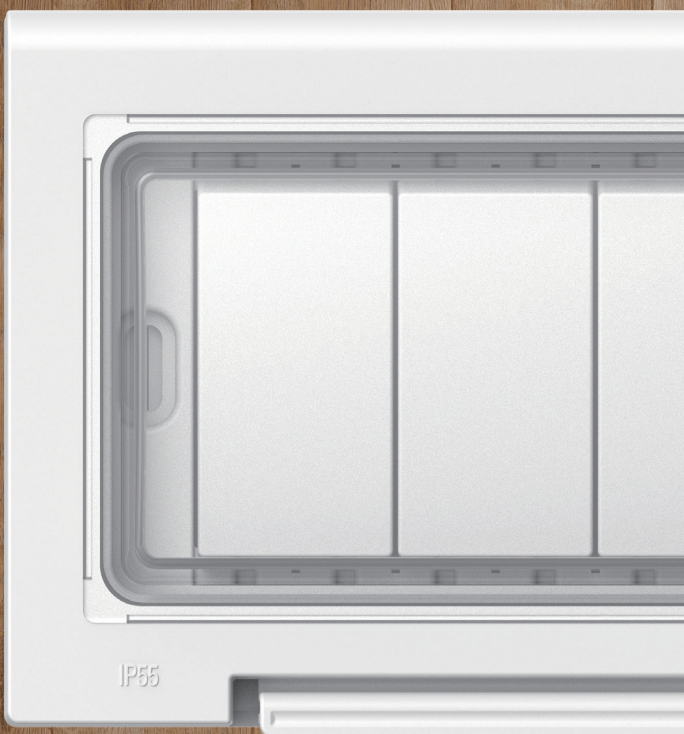

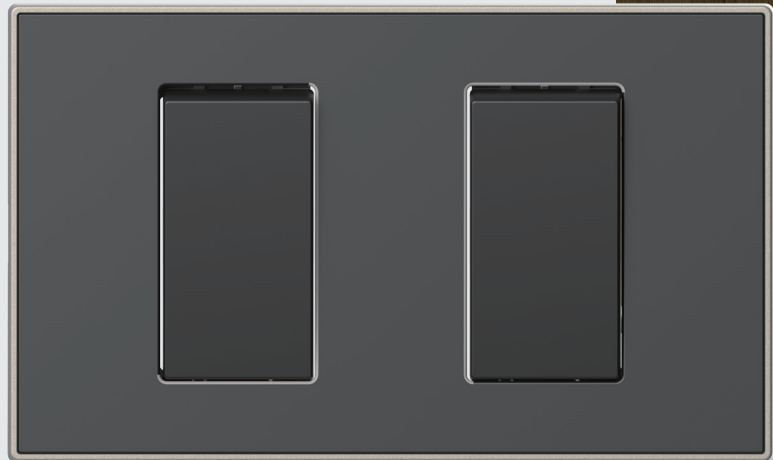
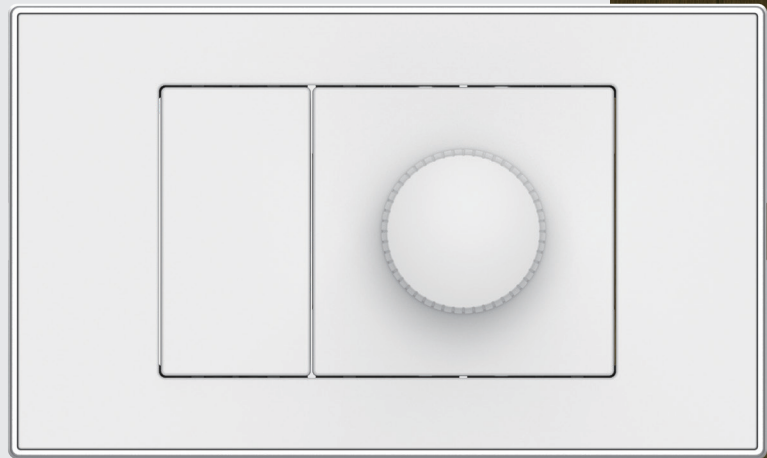



Unlimited Creativity, Have It Your Way.

Different function modules with different colored frames provides unlimited possibilities for your unique switch design, no matter it's to complement a piece of furniture or a wall painting, or to express yourself.

Details matter

Precise structure and selected materials.
Guarantees $\geq 40,000$ times switch life.
And $\geq 10,000$ times plug life.

PC structure

Complete PC materials for all insulating parts, from Bayer, including plates and back housing. Flame and heat resistance. Uniform color, never fade, Anti-UV. Eco friendly.



Silver alloy contacts

Increase contact area to effectively avoid electric arcs and guarantee safe switching on/off.



Integral wiring terminals

Optimized materials and simplified structure.

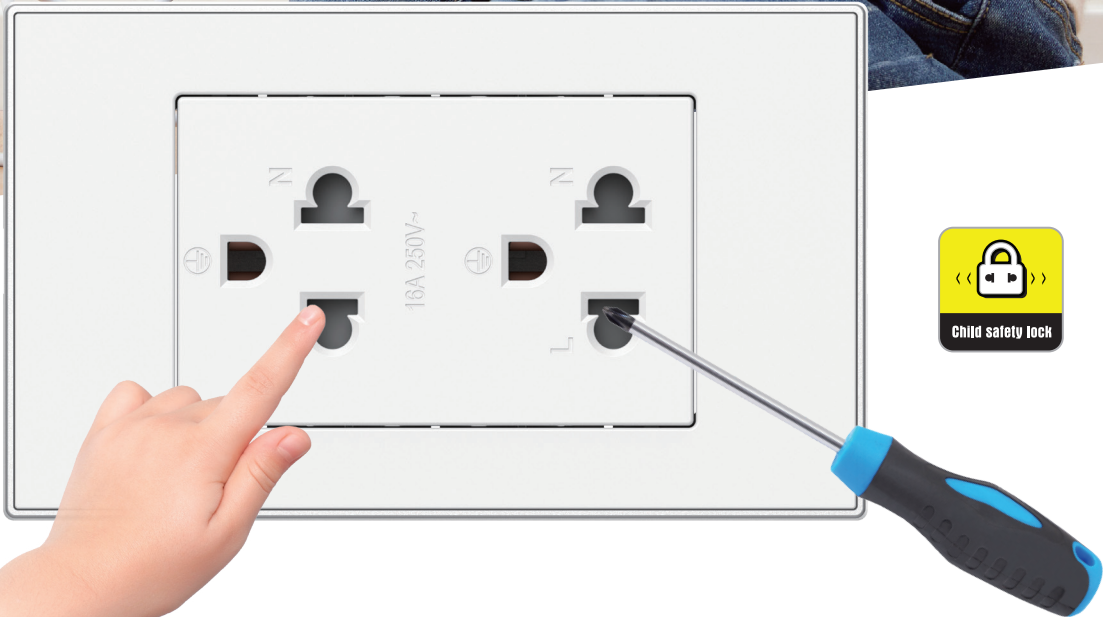

Robust quality, safe to use

By using a unique self-locking mechanism, 57 series rejects any plugs by abnormal objects, and the switches applies the U type spring toggle, faster cutoff in $0.003s$, **50%** shorter than normal switches which decreases arc generation and extends product lifetime. 57 series also adopts silver alloy contacts for better conductivity and efficiency. Resistant to abrasion and anti-oxidant. In addition, the quality PC material ensures a stable and robust structure.

Simon|57

Various Colors, Unlimited Creativity

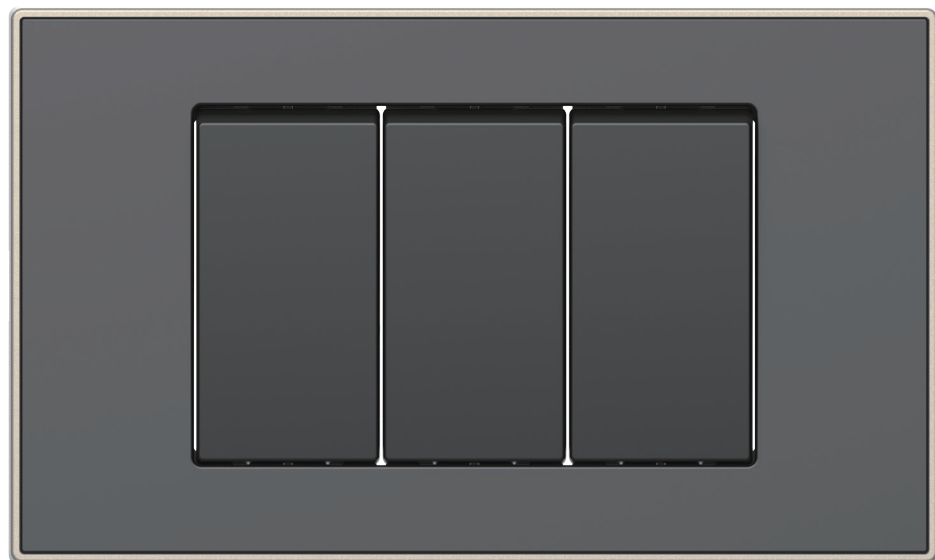

Infinite Possibilities in Switch Design

Modular Combinations, Customizable Function Modules

Durable PC Material-Safe & Heatproof



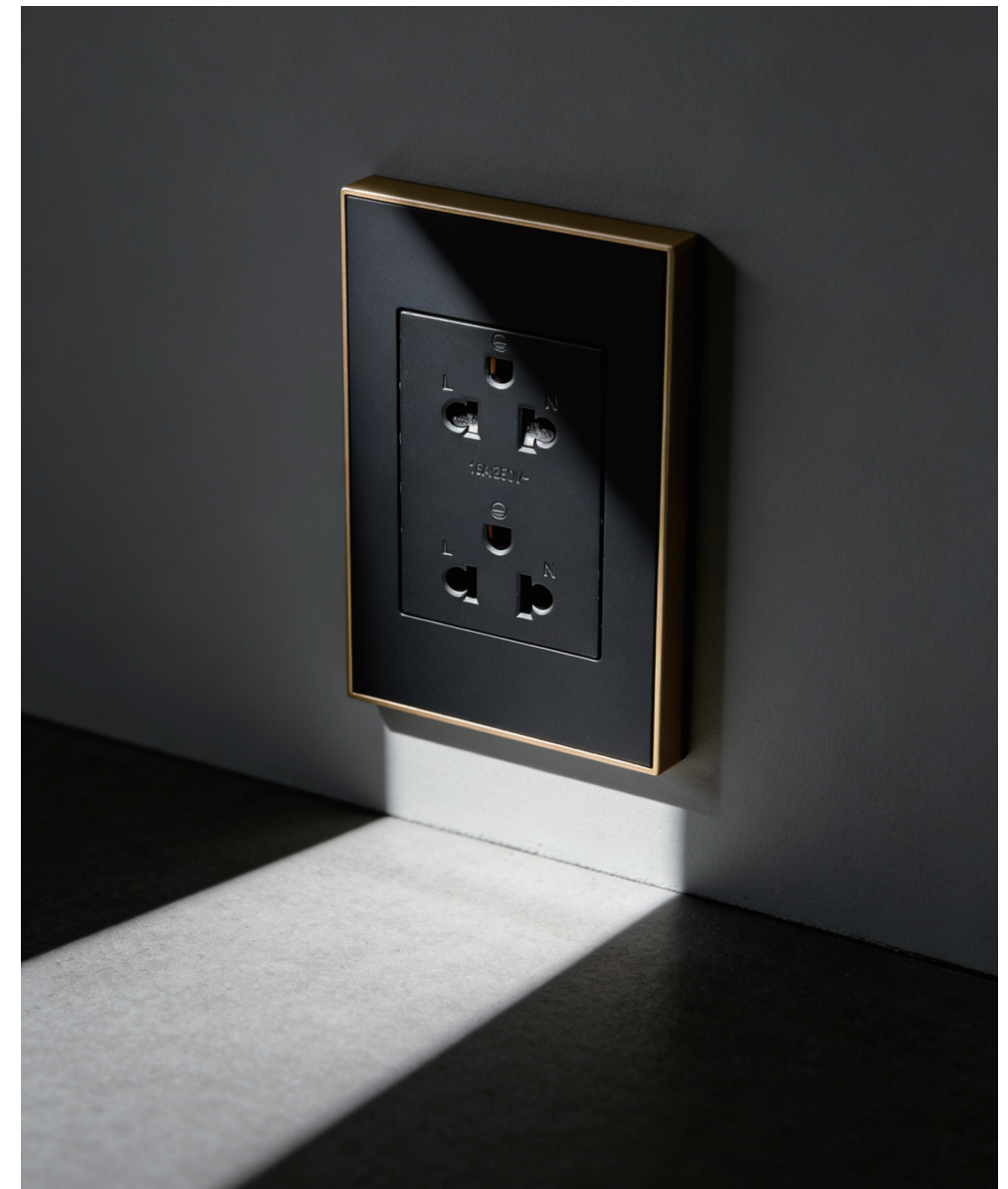
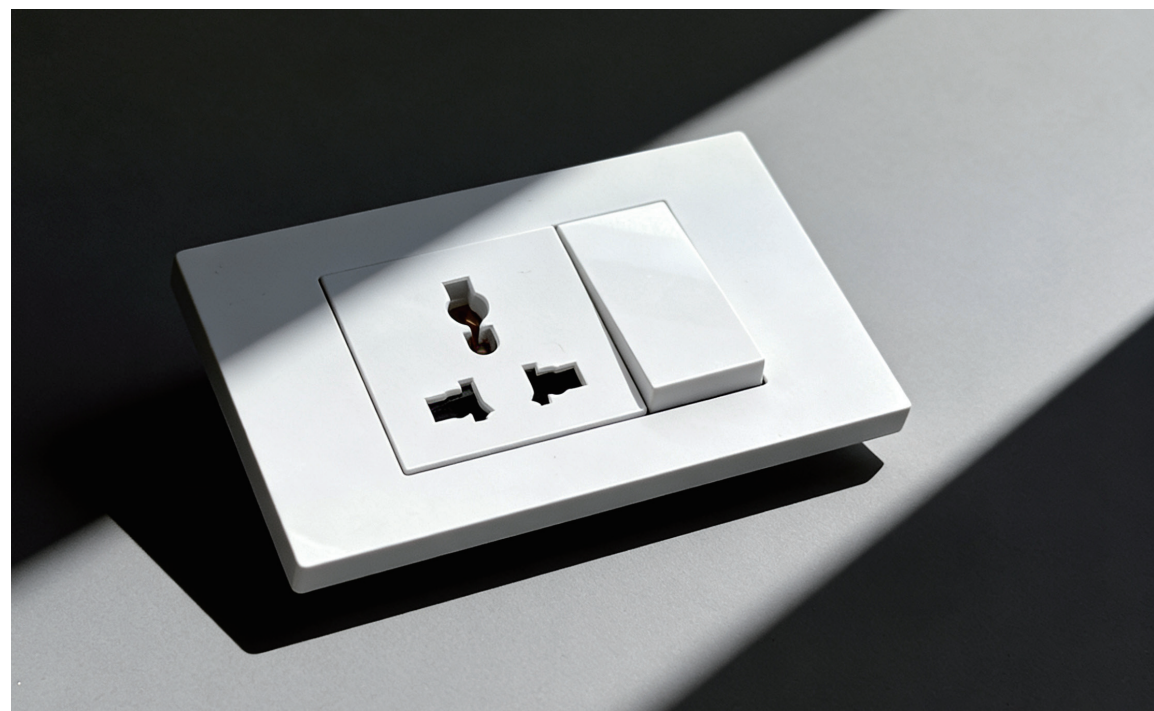

Various Colors, Customize Your Space

No longer limited to plain white or black.
Now with 57 series, choose your style and customize your space.

Various Colors, Customize Your Space

The mysterious black, the classic gold, or the sleek silver, all can be combined to add a unique vibe to the space.



COLOUR ▶

White

-26
Black

Switches

N1011/11 Way Switch Module (M)
(16AX 250V)**N1012/1**2 Way Switch Module (M)
(16AX 250V)**N1026**Intermediate Switch Module (M)
(10AX 250V)**N1623**1 Way 16A Double Pole Switch
Module with LED (M)
(16AX 250V)**N1017**Curtain Switch Module (M)
(10A 250V)**N1018**Push button Curtain
Switch Module (M)
(10A 250V)**N1302/1**Doorbel Switch Module (M)
(16A 250V)**N1301/1**Push-button Switch Module (M)
(16A 250V)**N1303/1**Push-button Switch
Module with LED (M)
(16A 250V)**N1021/1**1 Way Switch Module (2M)
(16AX 250V)**N1022/1**2 Way Switch Module (2M)
(16AX 250V)**N1046**Intermediate Switch Module (2M)
(10A 250V)

Socket

N1089Multi-standard Socket Module(2M)
(13A 250V)**N1678/1**Israeli Socket Module(2M)
(16A 250V)**N1687**Schuko Socket Module(2M)
(16A 250V)**NE727**

USB(5V 3A)+TYPE-C(20W) (M)



COLOUR ▶

White

-26
Black**N1071**2 Pin Socket Module(M)
(10A 250V)**N2081**20A Aircon Socket Module(2M)
(20A 250V)**N1287**Twin EU-US with Earth
Socket Module(3M)
(13A 250V)**N1187**Single EU-US with
Earth Socket Module(2M)
(16A 250V)

Tel, TV and Data Outlets

N5111TV Outlet F type
connector Module (M)**N5216**Telephone
Outlet Module(RJ12) (M)**N5214**Telephone
Outlet Module(RJ11) (M)**N5218**

Data Outlet Module (Cat.6) (M)

**N5100**

Blank Plate Module (M)

**NE102**

Dimmer Switch Module (2M)

**NE201**

Fan Regulator Switch Module (2M)



others

N2580Waterproof Cover
(for 2/3M Modules)

*combined with Base plate

N2584Waterproof Cover
(for 4M Modules)

*combined with Base plate

COLOUR ▶

White

-5A
White+Silver

-6Y
White+Champagne

-6Z
Black+Graphite

-6W
Black+Gold

-5B
Black+Silver

Frame(74)

*combined with Base plate

N5701

Horizontal 118*74 Frame
(for 1M Module)

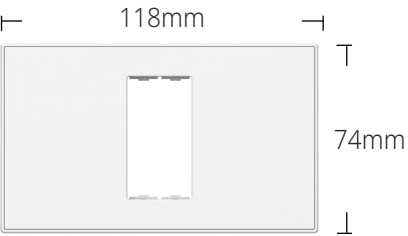

N5702

Horizontal 118*74 Frame
(for 2*1M Modules)

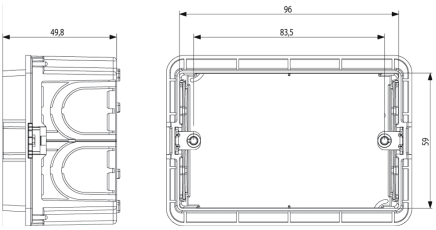
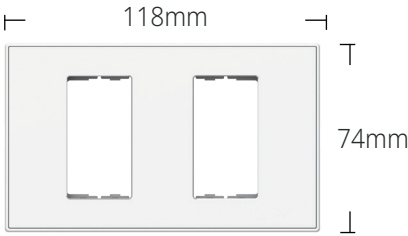

N5703

Horizontal 118 Frame
(for 3M Modules)



N5702A

Horizontal 118*74 Frame
(for 2M Modules)

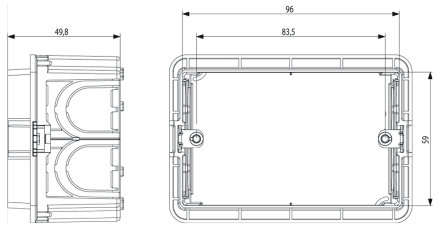

N5786

Horizontal 86*86 Frame
(for 2M Modules)



Mounting Box
(for 86 Base plate)

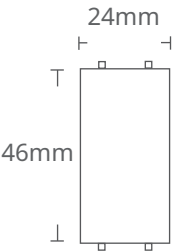
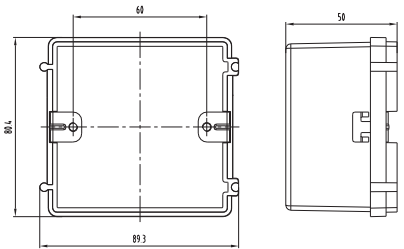

1M module
24x46mm

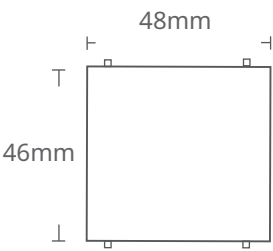

2M module
48x46mm

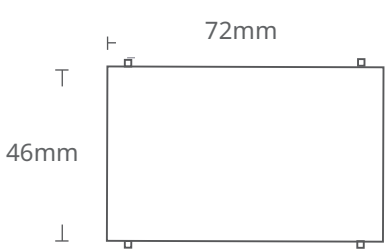

3M module
72x46mm

— **simon** —
LIGHT UP
EMOTIONS