

Applications

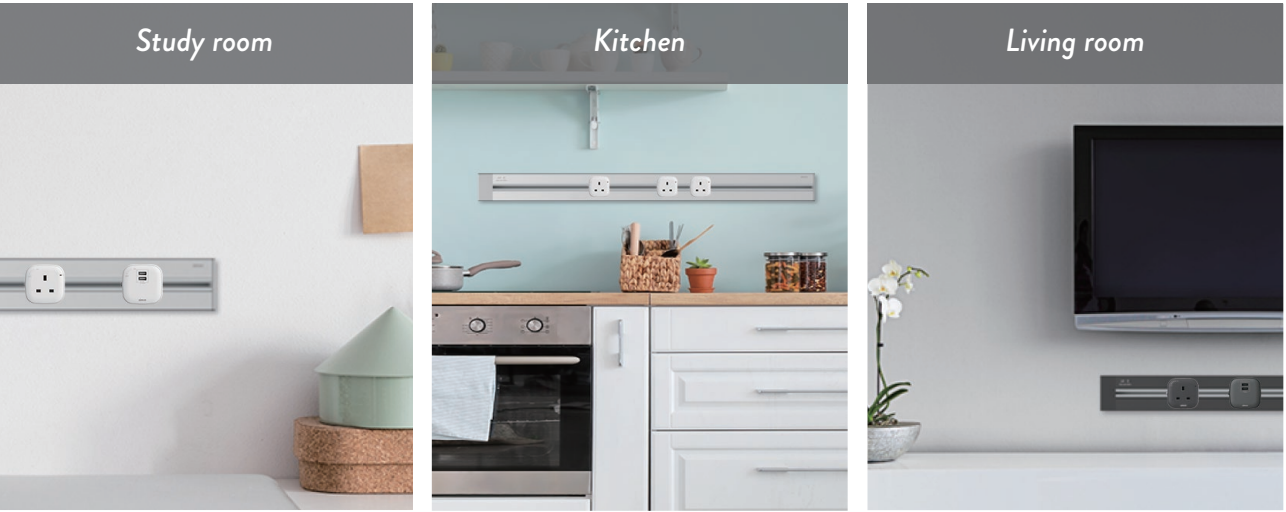

Convenience

Allows for easy socket module removing and repositioning.

Order

Adding new module is simple, get away with the massive cables.

Safe

Triple safety design.



Tracks		
Installation	Wiring	Customized
Surface	Need 3 wires: line, neutral, and earth.	Straight connect (0.4-2.5m) L-shape connect
Recessed	Recommend 6mm <sup>2</sup> cable.	Straight connect (0.4-2.5m)

Surface-mounted track		
Code	Product Description	Product size/mm
FTS4506-SL	Surface-mounted Power track-0.6m-Silver	600*80*20
FTS4506-BL	Surface-mounted Power track-0.6m-Black	
FTS4508-SL	Surface-mounted-Power track-0.8m-Silver	800*80*20
FTS4508-BL	Surface-mounted-Power track-0.8m-Black	
FTS4510-SL	Surface-mounted-Power track-1m-Silver	1000*80*20
FTS4510-BL	Surface-mounted-Power track-1m-Black	
FTS4512-SL	Surface-mounted-Power track-1.2m-Silver	1200*80*20
FTS4512-BL	Surface-mounted-Power track-1.2m-Black	

Recessed-mounted track			
Code	Product Description	Product size/mm	Cutout /mm
FTS5006-SL	Recessed-mounted-Power track-0.6m-Silver	600*82*25	588*74*24
FTS5006-BL	Recessed-mounted-Power track-0.6m-Black		
FTS5008-SL	Recessed-mounted-Power track-0.8m-Silver	800*82*25	788*74*24
FTS5008-BL	Recessed-mounted-Power track-0.8m-Black		
FTS5010-SL	Recessed-mounted-Power track-1m-Silver	1000*82*25	988*74*24
FTS5010-BL	Recessed-mounted-Power track-1m-Black		
FTS5012-SL	Recessed-mounted-Power track-1.2m-Silver	1200*82*25	1188*74*24
FTS5012-BL	Recessed-mounted-Power track-1.2m-Black		

Outlet module		
Code	Product Description	Product size/mm
MTS1189	Multi-standard socket-Square-WH	68*68*28
MTS1189-BL	Multi-standard socket-Square-BK	68*68*28
MTS1089	Multi-standard socket-Round-WH	Φ 69*28
MTS1089-BL	Multi-standard socket-Round-BK	Φ 69*28
MTS1381	13A BS socket-Square-WH	68*68*28
MTS1381-BL	13A BS socket-Square-BK	68*68*28
MTS1688	Schuko socket-Round-WH	Φ 69*28
MTS1688-BL	Schuko socket-Round-BK	Φ 69*28
MTSE721	USB Outlet-Square-WH(DC5V2.1A)	68*68*28
MTSE721-BL	USB Outlet-Square-BK(DC5V2.1A)	68*68*28
MTSE722	USB Outlet-Round-WH(DC5V2.1A)	Φ 69*28
MTSE722-BL	USB Outlet-Round-BK(DC5V2.1A)	Φ 69*28

simon

Barcelona • Belo Horizonte • Brussels • Buenos Aires • Casablanca • Hanoi Istanbul • Kiev • Lima • Lisbon • Madrid • Mexico D.F • Moscow • New Delhi Paris • Sao Paulo • Shanghai • Turin • Warsaw • Jakarta

**SIMON, S.A.**  
Tel. +34 902 109100  
Web. [www.simonelectric.com](http://www.simonelectric.com)

**Vietnam Office of Simon Electric**  
Tel. +84 24 3222750  
Web. [www.simon-apac.com](http://www.simon-apac.com)

**Simon Electric (China)**  
Tel. +86 21 3855 5222  
Web. <https://www.simon.com.cn/>

**PT Simon Elektrik Indonesia**  
Tel. +62 21 52960373  
Web. [www.simonelektrik.co.id](http://www.simonelektrik.co.id)

**Simon Electric (APAC)**  
Web. [www.simon-apac.com](http://www.simon-apac.com)  
E-mail. [info@simon-apac.com](mailto:info@simon-apac.com)



# Simon Track Socket

Less space, more outlets

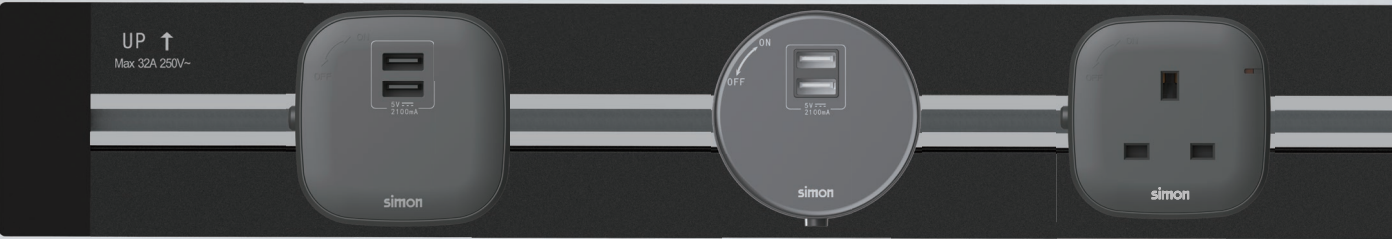

- 

Instant use
- 

Max power support
- 

Superior safety
- 

Clean and beauty
- 

Freely sliding
- 

Simple installation



# Simon since 1916 from Barcelona

Simon is an international company with more than 105 years history. Headquartered in Barcelona, Simon is made up of 25 companies throughout the world, and with presence over 90 countries.

Our solutions:

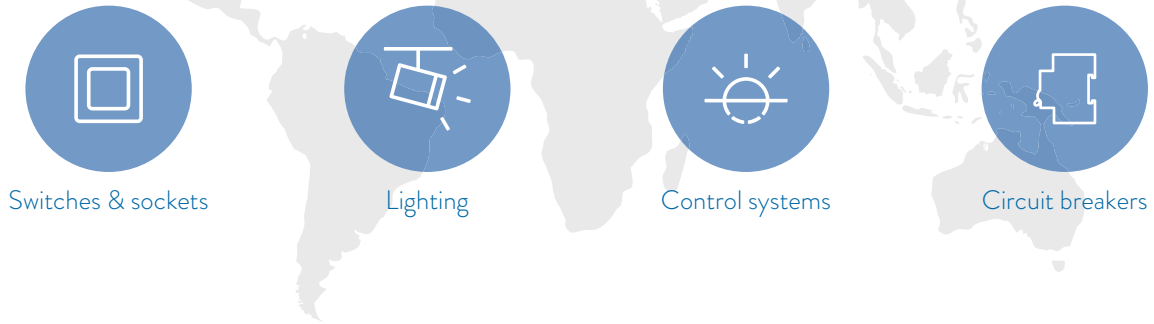

## Simon Track Socket, a flexible, practical and pleasant power solution.

### General guide

A single track can support a maximum power of **8000W**.  
Able to support multiple appliances at the same time.

Outlet modules can be repositioned freely into different spot on the track.

\*Maximum power of the individual socket module: 2500W

## Freely reposition, flexible adaptation

Outlet module can be slide freely on the track.  
Indicator of the socket module shows clearly power on or off.

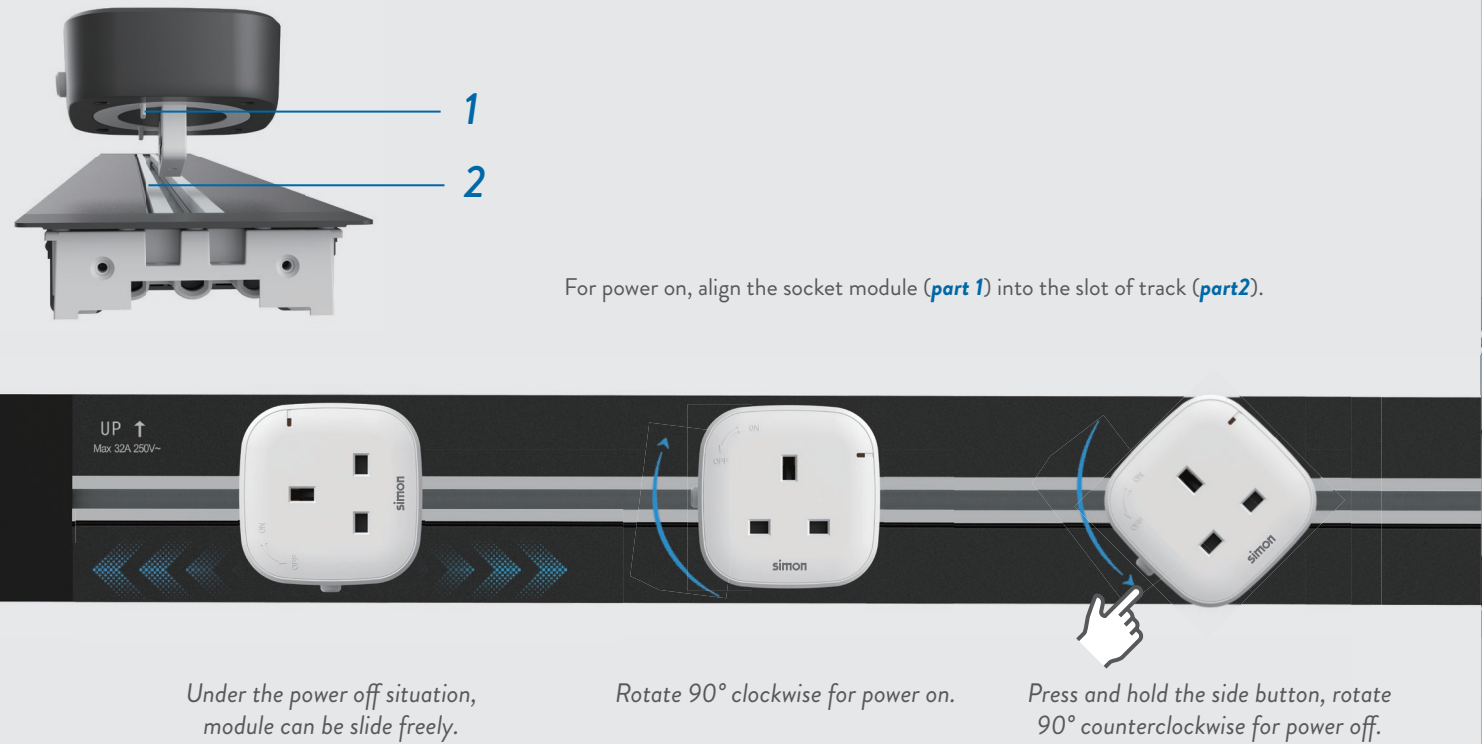

## Product design

### Color and shape

Two kinds of color or shapes available, to match different type of interior design.



### Socket option

Multiple options to satisfied different countries.



Multi-standard socket module

BS socket module

Schuko socket module

USB outlet up (2.1A 5VDC)

## Modern fashion, easy maintenance

Anodized aluminum surface material, longer service life.



## Triple design, 100% safety.

### 1. Slot design

- PVC insulation slot**  
Prevent electric shock even touching the surface.  
\*Do not insert the object without isolated protection into the slot.
- Copper component**  
0.6mm good quality copper clipper, excellent durable.

### 2. Shell design

- Shell with earth contact**  
For safety usage.

### 3. Shutter design

- Children safety lock**  
Shutter of the socket can prevent children from inserting conductive objects into sockets.